

ACTIVESHOP[®]

INSTRUCTIONS FOR USE

iWax Diamond wax warmer



Importer:

ACTIVESHOP Sp. z o.o.
Ul. Graniczna 8b, building
DC2A 54-610 Wrocław,
Poland

www.activeshop.com.pl

Rev. A/01/2025



Technical data:

Model: AX-900

Input voltage: 220-240V 50Hz Power:

100W

Dimensions: 18.5x18.5x14cm

Usage:

1. Remove the plastic lid.
2. Slide the handle slightly upward from the wax container for easier wax removal when you are done using the product.
3. Using the knob, set the temperature of the device to 100°C and wait for the wax to melt.
4. This process takes about 15min. If you want to speed it up put the lid on.
5. When the wax has dissolved, set the dial in the direction of the word , "MID". The device will keep the wax in liquid form.
6. Make sure the temperature of the wax is not too high by applying a minimal amount to the inside of your wrist.
7. When the wax runs out, pull the container out of the device using the plastic handle.
8. Turn off the warmer by turning the knob to the left and cover the device with the lid.
9. To clean the warmer, unplug it from the power supply, wait until it has cooled down enough (still remaining slightly warm) to wipe it with a cloth.
10. When using it again, repeat steps 1-6.

Cleaning the device:

1. Do not use solvents or strong cleaning agents.
2. Always unplug the device before cleaning
3. The device should not be soaked in water.
4. Do not use sharp objects for cleaning.
5. You can use a special liquid to remove wax residue.

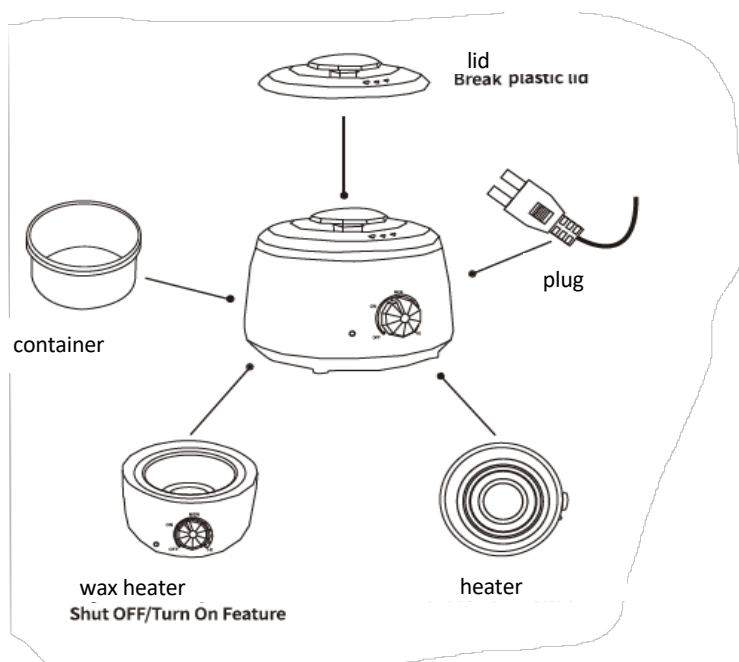

Caution:

-Do not place or store the device next to a sink or bathtub to avoid getting it wet.

-Do not immerse the device in water or other liquids. Ensure that the place where the heater stands is dry.

-If the device gets wet, unplug it from the power supply and do not touch the water. As with all electrical appliances, even when unplugged, the device remains electrified for some time.

WARNING: To reduce the risk of burns, electric shock, fire or injury:

1. Never use the device if:
 - a) It has a damaged cord or plug.
 - b) Does not work properly.
 - c) It has been dropped or damaged in any way.
 - d) Has fallen into water.
2. Adult supervision is important when the heater is used by or near children.
3. Keep the cord away from hot surfaces.
4. Do not immerse the heater in water or other liquids.
5. Avoid hanging the cord where it can be pulled by a child or accidentally knocked over.
6. Always use the heater on a stable surface.
7. Unplug the device from the power supply when not in use. Allow it to cool down before storing.
8. Do not wrap the cord around the heater during use.
9. Using accessories not recommended by the manufacturer can be dangerous.
10. Check the temperature before inserting your hand into the device.
11. Use the heater only for the purpose described in the instruction manual.

SAFETY MEASURES

1. The device is a professional equipment for use in beauty parlors. Use the device only by qualified cosmetic personnel to avoid undesirable consequences during treatment.
2. Do not disassemble the device or attempt to use it for purposes other than those indicated in this manual. All servicing and repairs must be performed only by an authorized service technician (ACTIV Tomasz Pacholczyk company).
3. Do not install or operate the device near liquids, wet places or with wet hands - so that no liquids get into the device.
4. Immediately unplug the device from the outlet and contact an authorized service provided by ACTIV Tomasz Pacholczyk in the following cases: a) liquid has gotten into the device, b) the device emits a strange smell, smoke or makes strange sounds, c) the power cord has been damaged, d) the device has been knocked over or its housing has been damaged.

5. Do not lay any objects on the cables. Do not install the device where someone may step on the power cord.
6. For safety purposes, unplug the power cord from the outlet each time you finish working with the device.
7. Do not insert anything into the opening of the device. If a foreign object gets into the hole, remove the cord from the outlet and contact the distributor or manufacturer.
8. Do not place the device on an unstable cart, shelf or vehicle. If dropped, the device may be damaged.
9. In order to guarantee the established useful life of the device, it is recommended to keep an interval of one minute before pressing the power button again (between switching on and off and vice versa).
10. The power supply must comply with the specifications on the nameplate. Otherwise, there is a risk of incorrect operation of the device its damage and even burning.

CAUTION:

1. In case of damage to the power cord or other malfunctions, contact an authorized service center - this will avoid danger.
2. This device can be used by children at least 8 years old and by people with reduced physical and mental capabilities and those with inexperience and lack of familiarity with the equipment, if supervision or instruction on how to use the equipment in a safe manner is provided, so that the associated risks are understood.
3. The equipment is not intended for play by children. Do not allow children to play with the equipment.
4. Do not leave the equipment unsupervised when children or persons without sufficient knowledge in the use of the equipment are near it.
5. This electrical appliance is not a toy. Incorrect use or contact with the electrical appliance may pose a health risk or lead to death, so use and store the appliance out of the reach of children.



DISPOSAL OF THE DEVICE

Dispose of used electrical appliances, fixtures and packaging to raw material reprocessing centers in accordance with environmental protection principles. Do not dispose of electrical appliances in household waste containers. Follow in accordance with rules for

discarding this type of equipment. In order to protect the environment in accordance with Directive 2012/19/EC on waste electrical and electronic equipment, waste electrical equipment should be collected separately, and sent to collection centers for waste electronic and electrical equipment.

At the end of their useful life, and old appliances contain full-value recyclable components, so they should be handed over for reprocessing. Therefore, they should be handed over

to appropriate collection points, as well as they can also be handed over to the ACTIV Tomasz Pacholczyk Company.

STORAGE AND TRANSPORT

The device should be transported at a temperature of (-) 20 °C to (+) 50 °C only in its original packaging. Store the device in a well-ventilated place with a relative humidity of no more than 75%. Operating temperature from (+) 10 °C to (+) 40 °C. During storage and transportation processes, the device must not be thrown or dropped, exposed to mechanical shocks or atmospheric agents.